

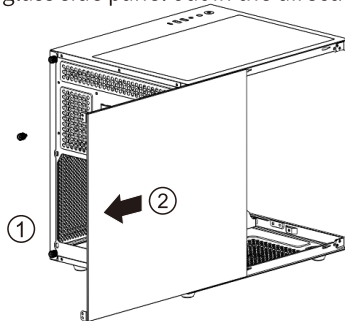

USER MANUAL OF V900

1 Disassembly of tempered glass side panel

- ① Unscrew the rear end of the left tamper glass side panel;
- ② Slide the tamper glass side panel out in the direction of the arrow



2 M/B installation

Put M/B in the case and align the screw holes, then fix M/B by screws as shown in the following illustration (this case support micro ATX M/B and ITX M/B) (different M/B has different installation characteristics, please refer to the user manual of your M/B before installation)

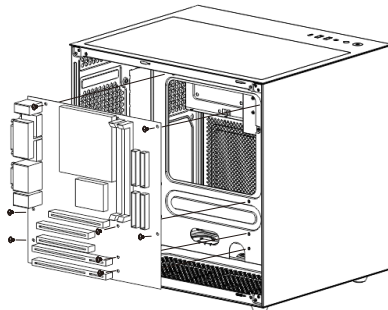

3 HDD / SSD installation (Support: HDD×1+SSD×3 or HDD×2+SSD×2)

- ① Knock down HDD/SSD bracket. Fix HDD×1 + SSD×1 or HDD×2 on the bracket. Re-install the HDD/SSD bracket in the chassis, align screw holes and fix the bracket at “a” positions;
- ② Bottom panel can be installed with SSD×2, align screw holes, fix SSD by screws from the bottom

- ① Fix HDD×1 + SSD×1 or HDD×2 on the HDD/SSD bracket

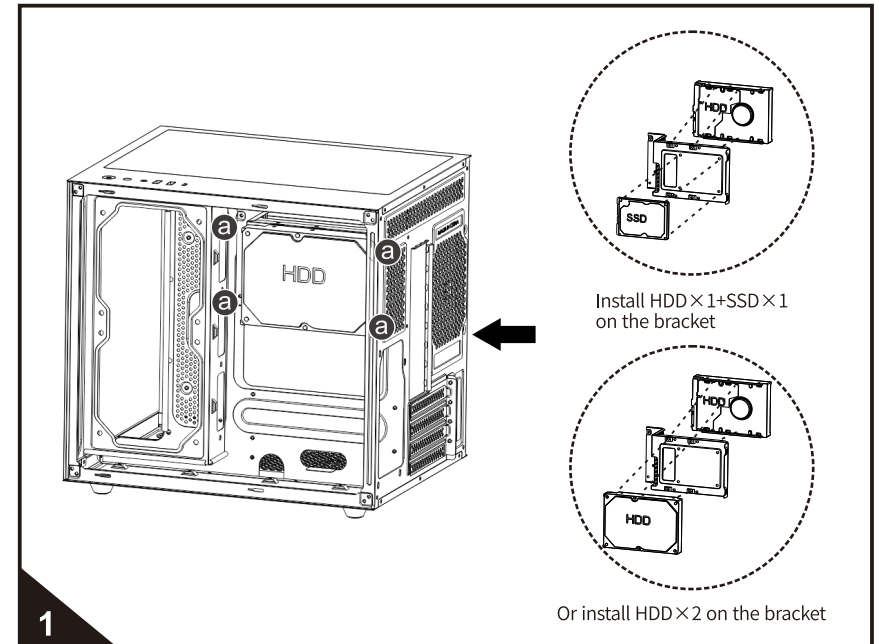

- ② Put SSD×2 on the positions of bottom panel as shown in the illustration

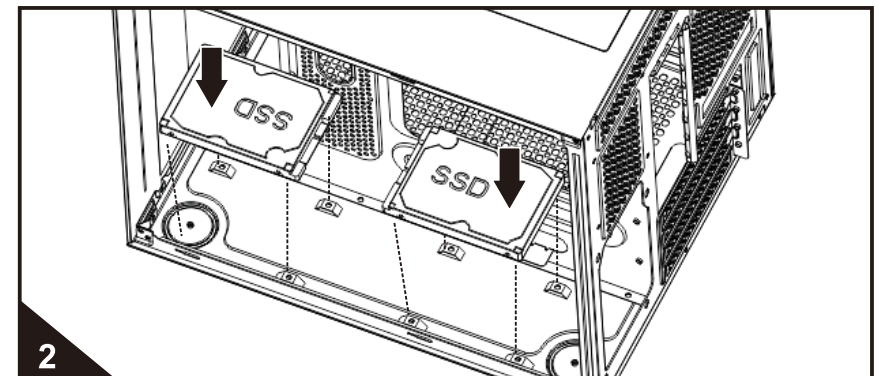

Bottom panel can be installed with SSD×2

4 显卡安装

- ① Unscrew the screws of the fastening bar of the PCI slot covers, remove the fastening bar, then break off PCI slot covers;
- ② Insert VGA card into the slot of M/B according to the arrow direction; Fix VGA card by screws

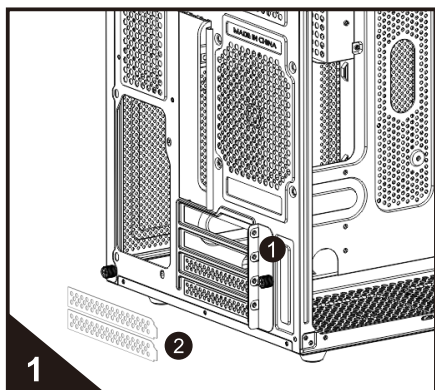

Unscrew the screws of the fastening bar of the PCI slot covers, remove the fastening bar, then break off PCI slot covers

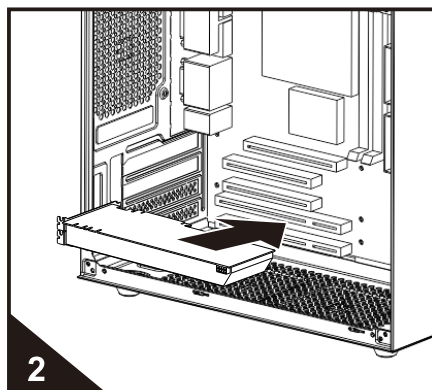

Insert VGA card into the slot of M/B according to the arrow direction

5 Control board installation

Put the 10 ports control board to the position as shown in the illustration, align screws holes, then fasten screw (Note: Control board is optional item. If the case comes without control board, then ignore it)

Caution! Please connect SATA connector properly as shown in the following illustration before power on

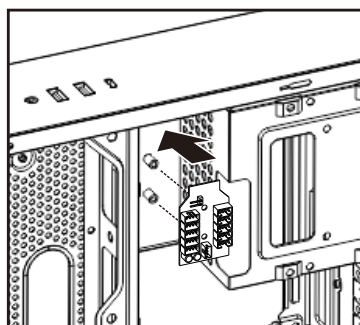
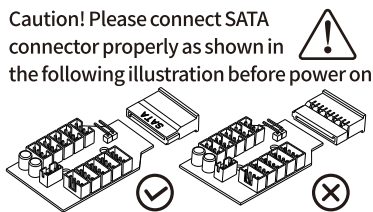

Port for switch button

The control board can control the LED light of connected ARGB fan, ARGB illuminating board. Press and hold for 5 seconds to switch to M/B sync

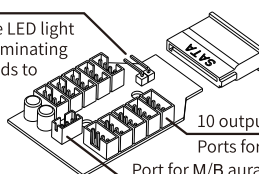

10 output ports of small 4pin
Ports for connecting fan and illuminating board
Port for M/B aura sync

Take out Aura cable from the accessories box, connect small 3pin of the Aura cable with this port, and connect another connector of 5V 3pin (Aura connector) to the M/B Aura port

6 PSU installation

Install PSU in the position as shown in the illustration, then fix it by 4 screws at "a" positions

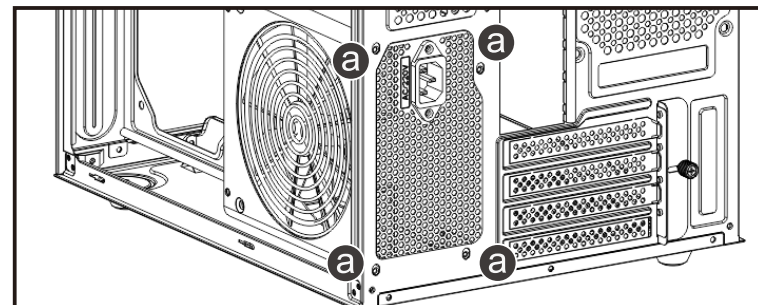

7 Cooling device compatibility

Top panel: 2×12cm fan; or 1×240mm radiator;
or 2×14cm fan; or 1×280mm radiator
Rear panel: 1×12cm fan or 1×120mm radiator
Bottom panel: 2×12cm fan
M/B bracket: 2×12cm fan

